

MBX10 Xenon Strobe Beacon

The MBX10 is a 10 Joule Xenon strobe beacon featuring a robust, fire retardant, IP66 & IP67 enclosure; suitable for harsh environments.

The 'M' series of products have been designed to withstand the harshest of environments. Constructed from lightweight, impact and fire resistant ABS, the range features stainless steel, ratchet adjustable mounting brackets and has been third party tested to IP66/67.

Features

- Automatic synchronisation on multi-beacon system.
- Beacons can be set to 'flip-flop' alternating mode with other units on multi-beacon systems.
- Xenon tubes mechanically secured against shock & vibration
- Glass lens & Stainless Steel guard
- Very large termination area.
- Dual M20 cable entries - adaptors available.
- Stopping plug included.
- Ratchet adjustable stainless steel 'U' bracket.
- Reverse polarity diode fitted.
- Ingress protection IP66/67 Type 4/4X/13
- 380 effective candela light intensity.
- 87,590 peak candela light intensity.
- UV stable PC, field replaceable, colour lens filter.

Approvals

- GOST-R approved. Cert: POCC GB.JB05.H00144.



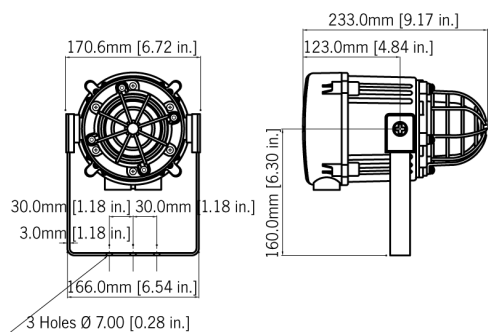

Specification

| | |
|---------------------|---|
| Energy: | 10 Joules (10Ws) |
| Flash rate: | 1Hz (60 fpm) |
| Peak Candela: | 1,000,000 cd - calculated from energy (J) |
| Eff. Intensity cd: | 500 cd - calculated from energy (J) |
| Peak Candela: | 87,590 cd* - measured ref. to I.E.S. |
| Eff. Intensity cd: | 380 cd* - measured ref. to I.E.S. |
| Lens colours: | Amber, Blue, Clear, Green, Magenta, Red & Yellow |
| Voltages DC: | 12vdc; 24vdc; 48vdc |
| Voltages AC: | 115vac; 230vac |
| Ingress protection: | IP66/67 Type 4/4X/13 |
| Housing material: | High impact UL94 V0 & 5VA FR ABS |
| Colour: | Grey (RAL7038) |
| Cable entries: | Dual M20x1.5 or 1/2"NPT |
| Lens material: | Borosilicate glass dome with PC prismatic lens cover. |
| Guard: | Stainless Steel dome guard as standard |
| Terminals: | 0.5 - 2.5mm ² (20-14 AWG) |
| Operating temp: | -25 to +55°C [-13° to +131°F] |
| Storage temp: | -40 to +70°C [-40 to +158°F] |
| Relative humidity: | 90% at 20°C [68°F] |
| Weight: | 1.48kg/3.25lbs |

*Candela measurements representative of performance with clear lens at optimum voltage.

Part Codes

| Part Code: | Ident.: | Description: |
|-----------------------------|---------|----------------------------|
| Product type: | MBX10 | Xenon Strobe Beacon |
| Voltage: | AC115 | 115V ac 50/60Hz |
| | AC230 | 230V ac 50/60Hz |
| | DC012 | 12V dc (10-14V dc) |
| | DC024 | 24V dc (20-28Vdc) |
| | DC048 | 48V dc (42-54V dc) |
| Cable entries: [e] | A | M20x1.5 & ½" NPT |
| | B | M20x1.5 & M20x1.5 |
| | C | ½" NPT & ½" NPT |
| Stopping plug material: [m] | N | Nylon |
| Bracket & Guard: [s] | 1 | 304 (A2) Stainless Steel |
| | 2 | 316 (A4) Stainless Steel |
| Version: [v] | A1 | CE, EAC & Russian Maritime |
| Enclosure: [x] | G | Grey |
| Lens colour: [y] | A, B, C | Amber, Blue, Clear |
| | G, M, R | Green, Magenta, Red |
| | Y | Yellow |

e.g: MBX10DC024BN1A1G/R MBX10 Xenon Beacon in 24Vdc with dual M20 entries, nylon stopping plug, CE, EAC & RMRS compliant Grey enclosure with Red lens

Also available as the MC1X05 combined alarm sounder and Xenon beacon and the MC1LD2 combined alarm sounder and LED beacon.

NOTE: The MBX10 supersedes the MB010, maintaining compatibility with existing installations.

Current Consumption

| Version: | Voltage: | Current mA: |
|----------|----------------|-------------|
| 12V dc | 10-14V dc | 1.45A |
| 24V dc | 20-28V dc | 660mA |
| 48V dc | 42-54V dc | 340mA |
| 115V ac | 50/60Hz +/-10% | 250mA |
| 230V ac | 50/60Hz +/-10% | 110mA |