

Radio receiver

// RF Rx EN868-1-NPN, 24 VDC Order no.: 90590002

Features/Options

- EnOcean standard
- 1-channel: semiconductor output
- NPN output

- Transmitter/receiver assignment by teaching mode
- LEDs for indication of switching state
- SMA plug-in connector for external antenna

Dimensions

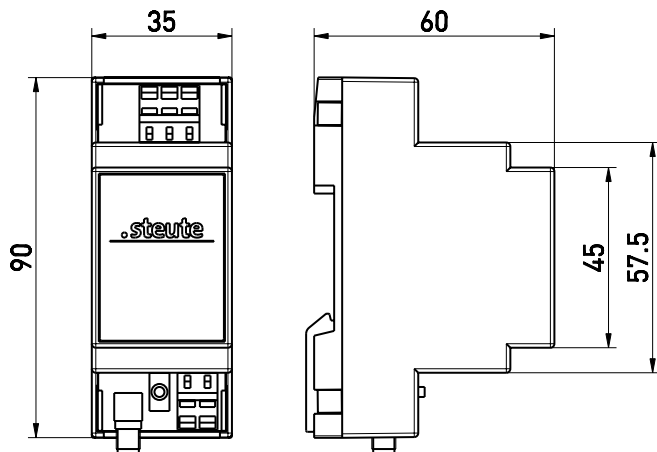

Arrangement of receiver and switch antenna



Optimum
mounting

Possible
mounting

Unsuitable
mounting

Note

The antenna must be mounted on a metal plate of min. 250 x 250 mm size.

Technical Data

Standards	EN 60947-5-1; EN 61000-6-2; EN 61000-6-3; EN 60068-2-6; EN 60068-2-27; EN 301 489-1; EN 301 489-3; EN 300 220-3
Number of channels	1
Mounting	DIN rail mounting
Screw terminals	terminals with CAGE CLAMP WAGO Serie 236: 0.08 ... 2.5 mm ² AWG 28-14 (incl. conductor ferrules)
Degree of protection	IP 20 per IEC/EN 60529
Inputs	1 radio channel, max. 10 transmitters per channel
Output	NPN (transistor)
Operating current I_e	Input: max. 0.08 A ; output: 0.2 A
Operating voltage U_e	Input: 24 VDC -15% ... +10%; output: UB-2.5 VDC
I_e/U_e of output contacts	6A / 250 VAC; 2A / 24 VDC
Utilisation category	DC-13
U_i	250 VAC
U_{imp}	2.5 kV
Frequency	868.3 MHz
Display	green LED: operating voltage, orange LED: switching conditions
Switching frequency	approx. 9000 telegrams at repetitions/h
Degree of pollution	2 per DIN VDE 0110
Ambient temperature	0°C ... +55°C
Storage and transport temperature	-25°C ... +85°C
Vibration resistance	NO 20g, NC 5g
Shock resistance	max. 100g
External antenna	always required for optimum sensing range
Note	inductive loads (contactors, relays etc.) are to be suppressed by suitable circuitry.
Weight	56g

Errors and omissions excepted.